

PAE61

FLOAT TYPE AIR ELIMINATOR

1/2", 3/4", 1"



DESCRIPTION:

PAE61 ball float air eliminator is designed to automatically discharge air/gas present in liquid systems without loss of liquid.

SIZES: NPS 1/2, 3/4, 1

CONNECTIONS: Screwed (NPT / BSPT / BSP)

LIMITING CONDITIONS:

PMA: Max. allowable pressure	250 psig
TMA: Max. allowable temperature	425 °F
PMO: Max. operating pressure	150 psig
Cold hydro test pressure	375 psig

AIR DISCHARGE CAPACITY AT 15 °C

DIFF. PRESSURE psig	ORIFICE SIZE	scfm
15	3/32"	1.05
30		1.90
50		3.00
75		4.05
100		5.25
125		6.40
150		7.60

INSTALLATION:

Vertical installation with flow from bottom to top. The air eliminator should be installed at all high points of a liquid system wherever air can collect. It should be installed vertically above the pipe or equipment with inlet at the bottom. The arrow on the nameplate should be pointing vertically upwards.

AVAILABLE SPARES:

Valve Seat, Ball Float & Lever Assly., Gaskets

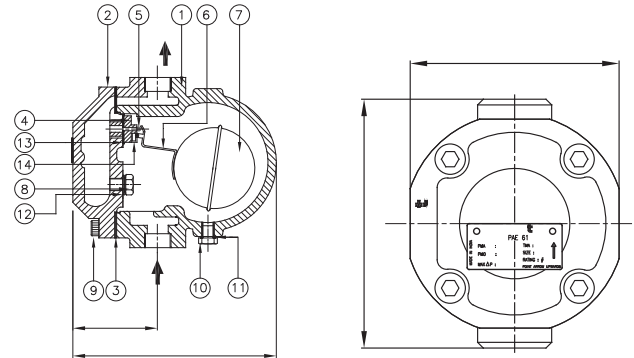

MATERIAL:

No.	PART	MATERIAL	QTY. (Nos.)
1.	BODY	CAST IRON	1
2.	COVER	IS : 210 FG200	1
3.	GASKET (COVER)	NON CAF	1
4.	VALVE SEAT	AISI 410 /	1
5.	VALVE	AISI 420	1
6.	LEVER	AISI 304	1
7.	FLOAT	AISI 304	1
8.	PLUG	AISI 304	1
9.	BOLT	HIGH TENSILE	4
10.	DRAIN PLUG	C.S	1
11.	GASKET DRAIN PLUG	COPPER	1
12.	GASKET PLUG	COPPER	1
13.	GASKET VALVE SEAT	COPPER	1
14.	BRACKET ASSLY.	AISI 304	1

WEIGHT: (approx): 7.25 lbs

ORDERING INFORMATION:

Refer 'How to Order' page

CAUTION:

DO NOT USE FOR HAZARDOUS/POISONOUS MEDIA

Local regulations may restrict the use of this product below the conditions quoted. Limiting conditions refer to standard connections only. In the interest of development and improvement of the product, we reserve the right to change the specifications without prior notice.